

# Too-Too Cory Carson<sup>®</sup>

## SmartPoint<sup>™</sup> Cory & Chrissy

### Parent's Guide

#### BATTERY REMOVAL AND INSTALLATION

1. Make sure the unit is turned **OFF**.
2. Locate the battery cover. Then, use a screwdriver to loosen the screw and remove the cover.
3. Remove old batteries by pulling up on one end of each battery.
4. Install 2 new AAA (AM-4/LR03) batteries following the diagram inside the battery box. (The use of new alkaline batteries is recommended for maximum performance).
5. Replace the battery cover and tighten the screw to secure.

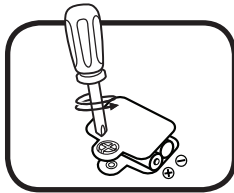

**WARNING:** All packing materials such as tape, plastic sheets, packaging locks, removable tags, cable ties and packaging screws are not part of this toy and should be discarded for your child's safety.

**NOTE:** Please keep this parent's guide as it contains important information.

#### Removing the packaging locks

- ① Rotate the packaging lock anticlockwise several times.
- ② Pull out the packaging lock and discard.

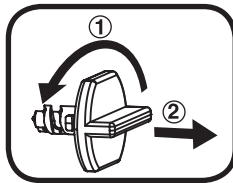

#### BATTERY NOTICE

- Use new alkaline batteries or fully charged NI-MH (Nickel Metal-hydride) rechargeable batteries for best performance.
- Use only batteries of the same or equivalent type as recommended.
- Do not mix different types of batteries: alkaline, standard (carbon-zinc) or rechargeable, or new and used batteries.
- Do not use damaged batteries.
- Insert batteries with the correct polarity.
- Do not short-circuit the battery terminals.
- Remove exhausted batteries from the toy.
- Remove batteries during long periods of non-use.

1

- Do not dispose of batteries in fire.
- Do not charge non-rechargeable batteries.
- Remove rechargeable batteries from the toy before charging (if removable).
- Rechargeable batteries are only to be charged under adult supervision.

#### Disposal of batteries and product



The crossed-out wheeled bin symbols on products and batteries, or on their respective packaging, indicates they must not be disposed of in domestic waste as they contain substances that can be damaging to the environment and human health.



The chemical symbols Hg, Cd or Pb, where marked, indicate that the battery contains more than the specified value of mercury (Hg), cadmium (Cd) or lead (Pb) set out in Battery Directive (2006/66/EC). The solid bar indicates that the product was placed on the market after 13th August, 2005.

Help protect the environment by disposing of your product or batteries responsibly.



For more information, please visit:

[www.recycle-more.co.uk](http://www.recycle-more.co.uk)

[www.recyclenow.com](http://www.recyclenow.com)

#### PRODUCT FEATURES

##### 1. On/Off Switch

To turn the unit **On**, slide the **On/Off Switch** to the **On**  position. To turn the unit **Off**, slide the **On/Off Switch** to the **Off**  position.

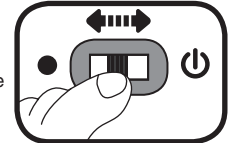

##### 2. Automatic Shut-Off

To preserve battery life, the **Too-Too Cory Carson<sup>®</sup>** character will automatically power down after approximately 60 seconds without input. The unit can be turned on again by pressing the **Light Up Button** or by pushing the character quickly.

**NOTE:** This product is in try-me mode in the packaging. After opening the package, turn the vehicle off and on again to proceed with normal play. If the unit powers down while playing, we suggest changing the batteries.

#### ACTIVITIES

##### 1. Light Up Button

Press the **Light Up Button** to hear sounds, songs, phrases and melodies. The light will flash with the sounds.

There will be different sounds when the **Top Button** is activated.

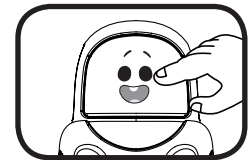

2

## 2. Stacking Fun

Stack the mini character on top of the big character to activate the top button and hear different responses. The lights will flash with sounds.



## 3. Sounds and Melodies

Push the big character to hear fun sounds. If a melody is already playing, push the character to add fun sounds on top of the melody. The light will flash with the sounds.

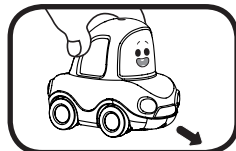

## 4. SmartPoint™ Locations

For added fun, the big character interacts with the **SmartPoint™** locations on **Toot-Toot Cory Carson®** play sets. Simply roll the character over the **SmartPoint™** location to see the light flash and to hear fun sounds, short tunes or sing-along songs. (Play sets sold separately).

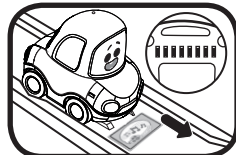

## 5. PlayZone Locations

The mini character interacts with **PlayZone** locations on **Toot-Toot Cory Carson®** play sets. Simply place the mini character on any **PlayZone** location to unlock unique phrases, fun sounds, short tunes or sing-along songs. (Play sets sold separately).

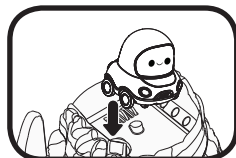

2. Interrupt the power supply by removing the batteries.
  3. Let the unit stand for a few minutes, then replace the batteries.
  4. Turn the unit **ON**. The unit should now be ready to play with again.
  5. If the product still does not work, install a new set of batteries.
- If the problem persists, please contact our Consumer Services Department and a service representative will be happy to help you.

## CONSUMER SERVICES

Creating and developing **VTech®** products is accompanied by a responsibility that we at **VTech®** take very seriously. We make every effort to ensure the accuracy of the information, which forms the value of our products. However, errors sometimes can occur. It is important for you to know that we stand behind our products and encourage you to call our Consumer Services Department with any problems and/or suggestions that you might have. A service representative will be happy to help you.

UK Customers:

Phone: 0330 678 0149 (from UK) or +44 330 678 0149 (outside UK)

Website: [www.vtech.co.uk/support](http://www.vtech.co.uk/support)

Australian Customers:

Phone: 1800 862 155

Website: [support.vtech.com.au](http://support.vtech.com.au)

NZ Customers:

Phone: 0800 400 785

Website: [support.vtech.com.au](http://support.vtech.com.au)

## Product Warranty /Consumer Guarantees

UK Customers:

Read our complete warranty policy online at [vtech.co.uk/warranty](http://vtech.co.uk/warranty).

Australian Customers:

**VTECH ELECTRONICS (AUSTRALIA) PTY LIMITED – CONSUMER GUARANTEES**

Under the Australian Consumer Law, a number of consumer guarantees apply to goods and services supplied by VTech Electronics (Australia) Pty Limited. Please refer to [vtech.com.au/consumerguarantees](http://vtech.com.au/consumerguarantees) for further information.

## CARE & MAINTENANCE

1. Keep the unit clean by wiping it with a slightly damp cloth.
2. Keep the unit out of direct sunlight and away from any direct heat source.
3. Remove the batteries when the unit is not in use for an extended period of time.
4. Do not drop the unit on hard surfaces and do not expose the unit to moisture or water.

## TROUBLESHOOTING

If for some reason the unit stops working or malfunctions, please follow these steps:

1. Turn the unit **OFF**.

3

CLASS 1  
LED PRODUCT

4

TM & © 2020 VTech Holdings Limited.  
All rights reserved.  
**Printed in China.**  
91-003806-001 UK